



GE Canada
Moteurs d'avions

CALYPSO.

version: 5.0.16



Thickness AE BV	
Actual	0.0431
-Tol.	0.0190
+Tol.	0.0490

Thickness AE BS	
Actual	0.0501
-Tol.	0.0240
+Tol.	0.0580

Thickness AE BN	
Actual	0.0610
-Tol.	0.0360
+Tol.	0.0690

Thickness AE BW	
Actual	0.0455
-Tol.	0.0190
+Tol.	0.0490

Thickness AE BT	
Actual	0.0515
-Tol.	0.0250
+Tol.	0.0590

Thickness AE BP	
Actual	0.0563
-Tol.	0.0360
+Tol.	0.0690

GDT Line Profile AE-AE	
Actual	0.0446
-Tol.	0.0000
+Tol.	0.0150

	.065
	.015

IN AREA BZ (B5)

Drawing Number: 2051M68

Run Number: 315

1/18/2011 3:27:11 PM

Section AE-AE

Thickness & Line Profile

BJ

R 1.40

R 1.00

R .70

.035

.065

.50

BZ

BV

BS

BN

BW

BT

BP

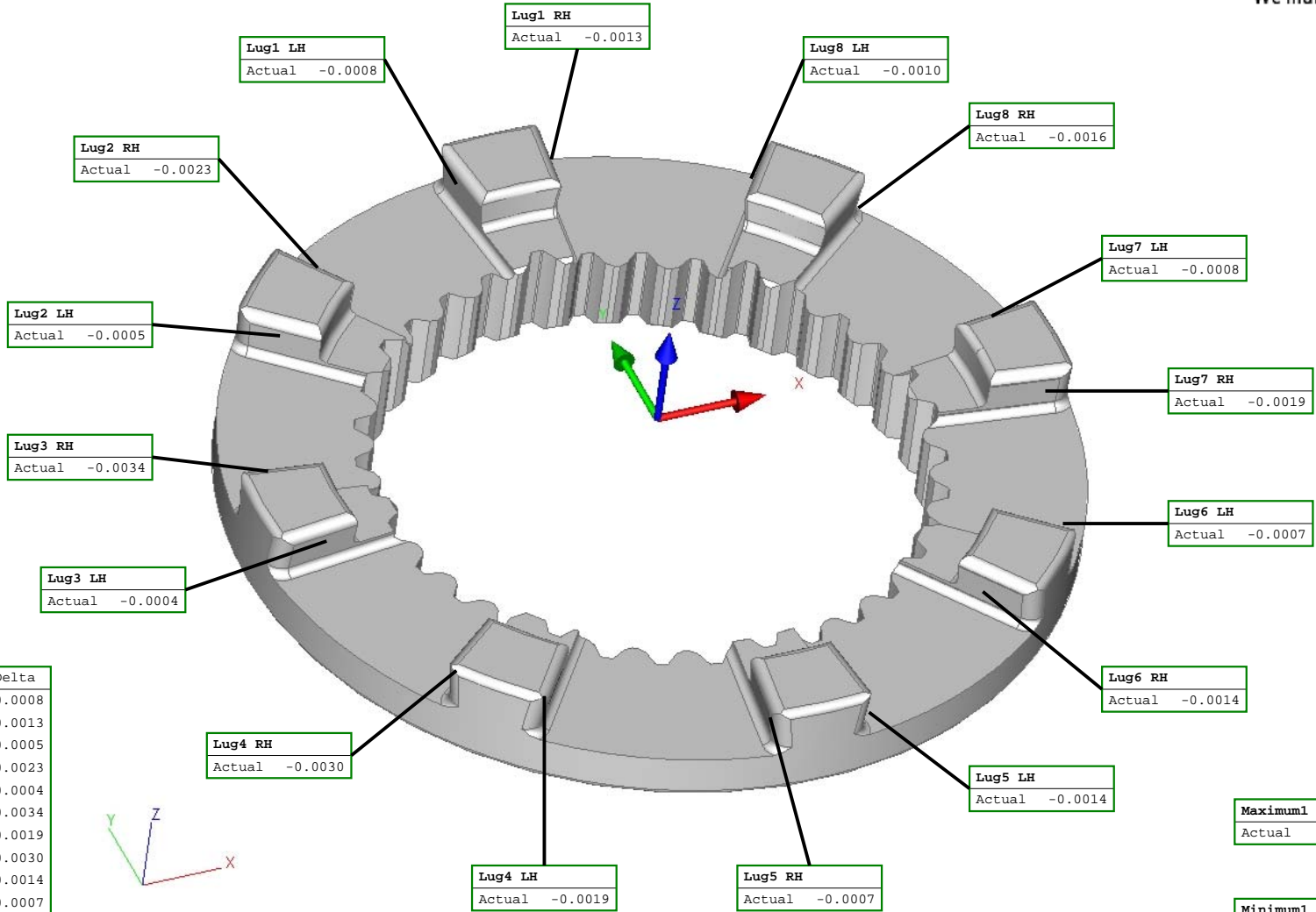

Group	Lugs	Nominal	Delta
Lug1	LH	0.0000	-0.0008
Lug1	RH	0.0000	-0.0013
Lug2	LH	0.0000	-0.0005
Lug2	RH	0.0000	-0.0023
Lug3	LH	0.0000	-0.0004
Lug3	RH	0.0000	-0.0034
Lug4	LH	0.0000	-0.0019
Lug4	RH	0.0000	-0.0030
Lug5	LH	0.0000	-0.0014
Lug5	RH	0.0000	-0.0007
Lug6	LH	0.0000	-0.0007
Lug6	RH	0.0000	-0.0014
Lug7	LH	0.0000	-0.0008
Lug7	RH	0.0000	-0.0019
Lug8	LH	0.0000	-0.0010
Lug8	RH	0.0000	-0.0016

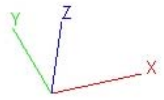

Positive value = too much material

Maximum1
Actual -0.0004

Minimum1
Actual -0.0034

Average1
Actual -0.0014

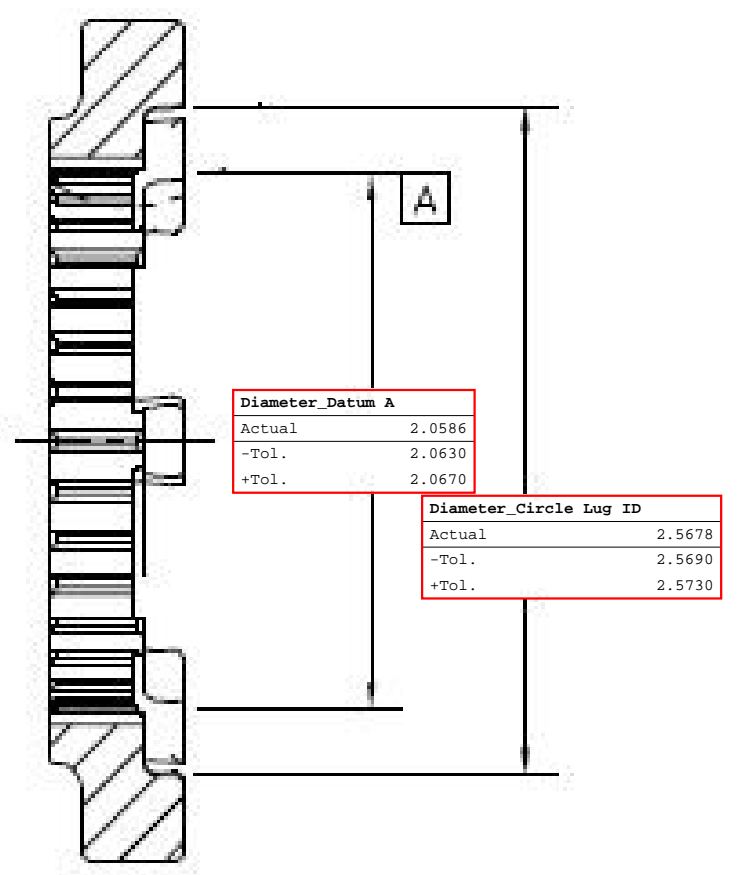
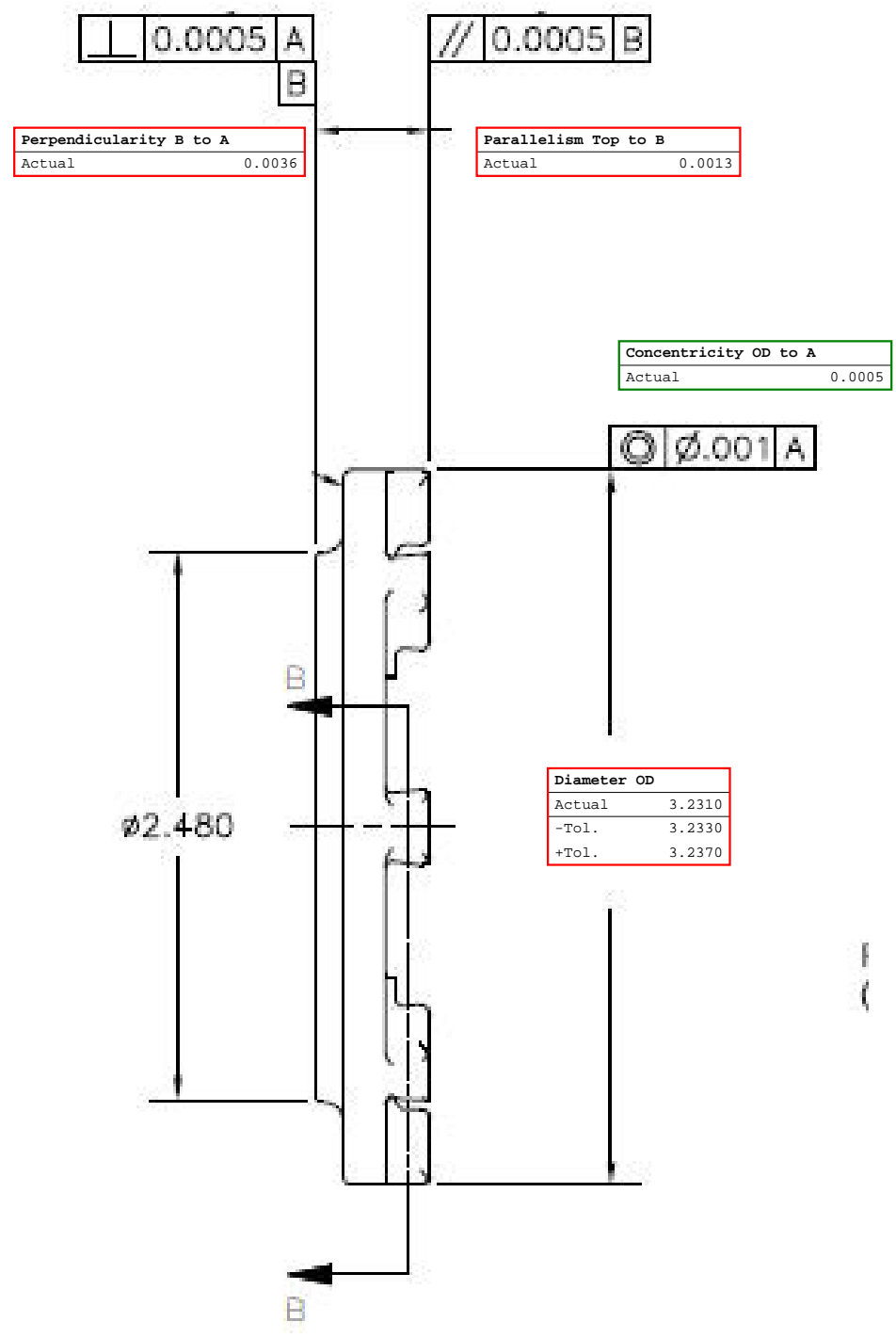

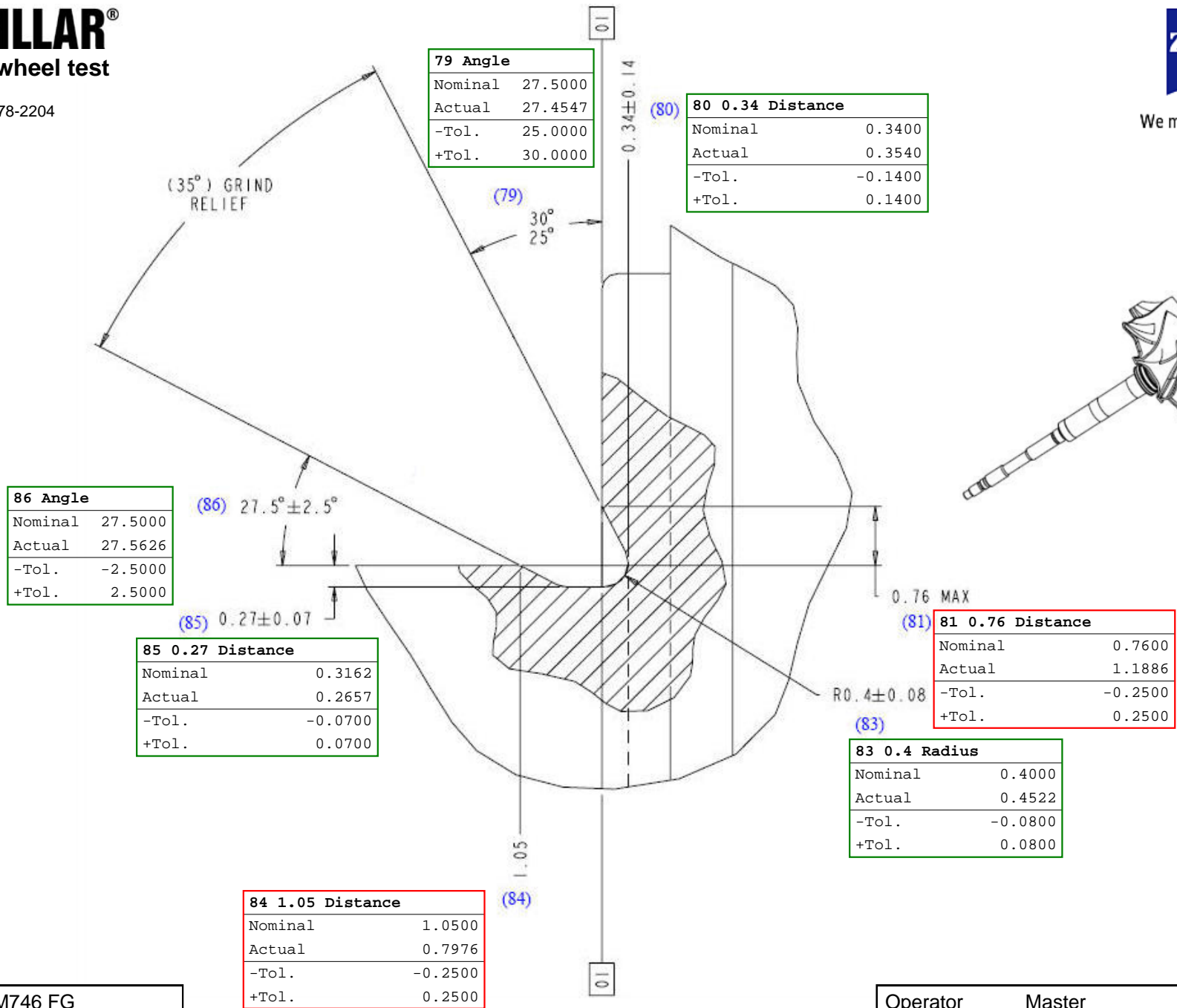

Detail "E"

Serial No.	M746 FG
Part No.	384-1600-00
Work Order	634261

Operator	Master
Program	CAT Shaft Sept 30 arr
Date/Time	9/22/2010 11:05:42 AM



CAT turbine wheel tes

Caterpillar INC.
Mossville, IL (309) 578-2204



We make it visible.



44 Diameter	27.996
Actual	27.9951
44 Location X	
Actual	0.0010
44 Location Y	
Actual	-0.0020



41 Diameter	17.846
Actual	17.8410
41 Location X	
Actual	-0.0005
41 Location Y	
Actual	0.0010



39 Diameter	16.668
Actual	16.6630
39 Location X	
Actual	0.0020
39 Location Y	
Actual	-0.0030



31 Diameter	13.4835
Actual	13.4785
31 Location X	
Actual	-0.0030
31 Location Y	
Actual	0.0021



37 Diameter	16.652
Actual	16.6471
37 Location X	
Actual	0.0031
37 Location Y	
Actual	0.0007



29 Diameter	9.5365
Actual	9.5314
29 Location X	
Actual	0.0014
29 Location Y	
Actual	0.0020

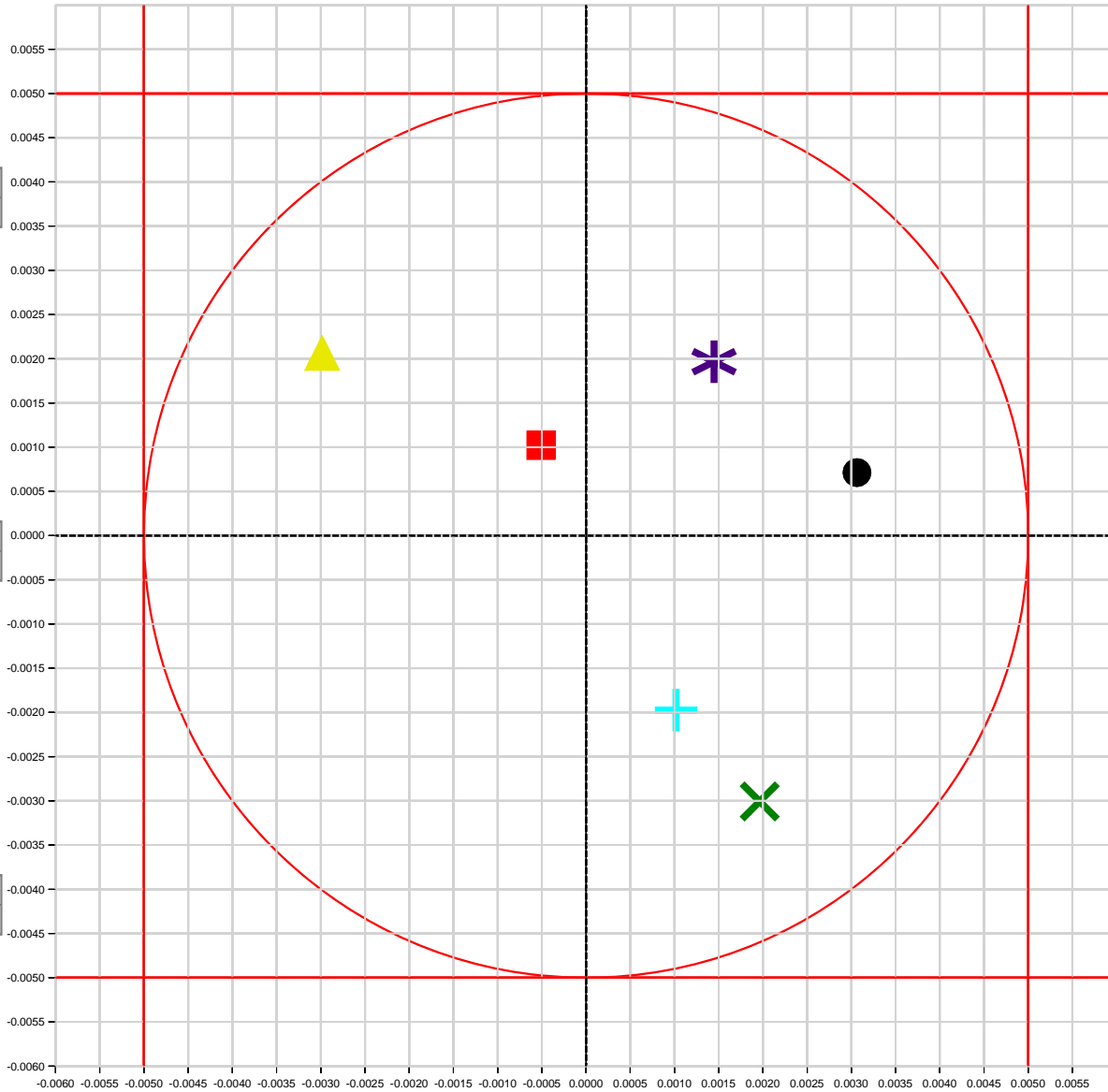

Timing Mark Here...

Serial No.	M746 FG
Part No.	384-1600-00
Work Order	634261

Operator	Master
Program	CAT Shaft Sept 30 arr
Date/Time	9/22/2010 11:05:42 AM



PiWeb FlexRepor...
Version: 3.6.8.0

Carl Zeiss

Date: 1/19/2011 10:11:51...
Order:



Part: White
Part number:

Departement:
Operator: mbusha

Last 10 measurements

- Home 1
- Datum A 2
- True Position 3
- Intersection Distance 4
- Bearing Bore 5
- Bore A2 6

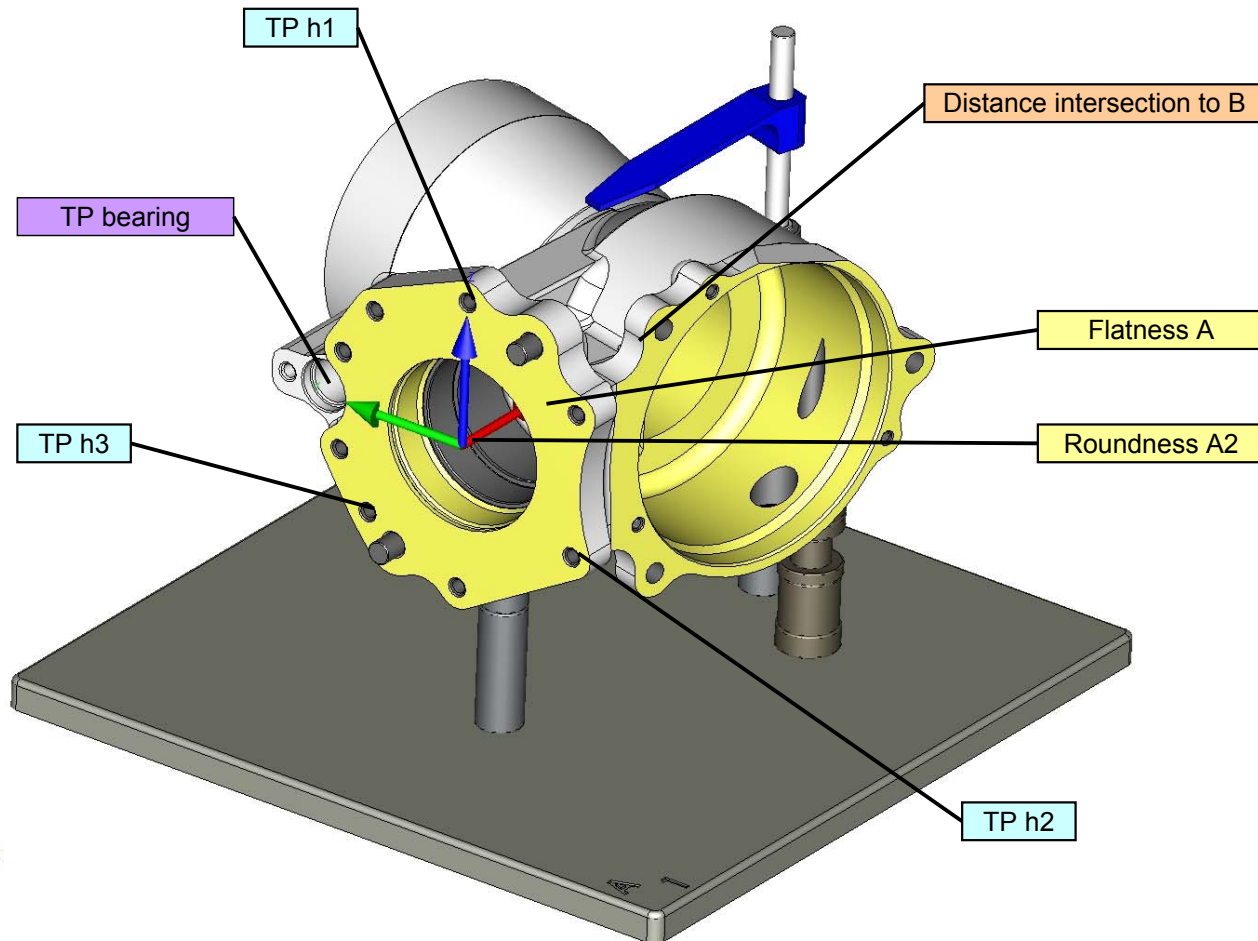

Print all pages



Flatness A

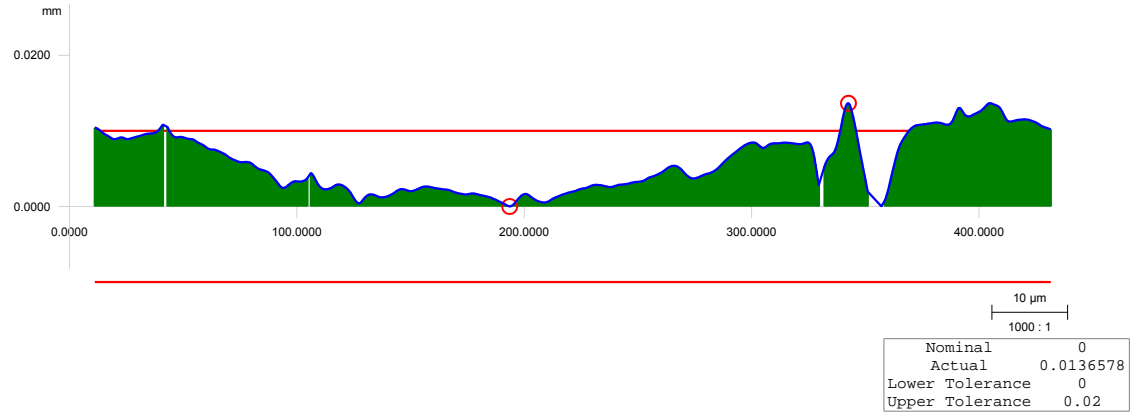
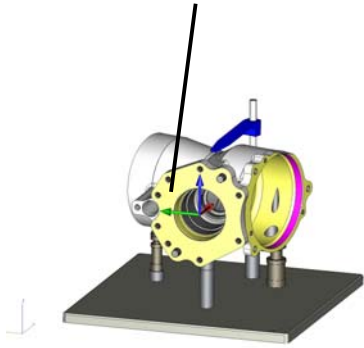

Flatness A

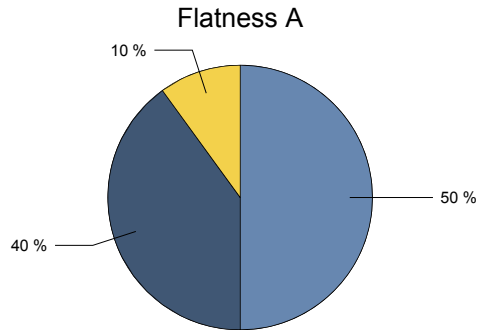
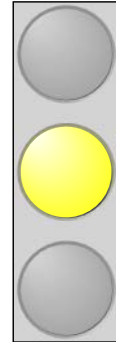

- 0.01275 to 0.0135
- 0.0135 to 0.01425
- 0.0165 to 0.01725

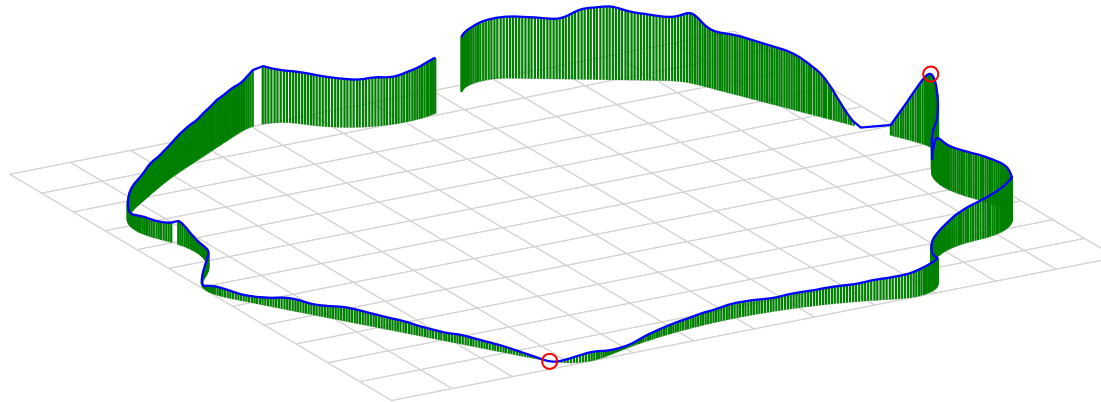

mm	X	Y	Z	
Edges	1	0.0000	58.9507	0.0010
	2	97.0448	0.0000	0.0049
	3	134.0211	58.9544	0.0136
	4	88.0420	122.3008	0.0112
Max	0.0137	134.0118	59.4425	0.0137
Min	0.0000	31.0806	3.2019	0.0000

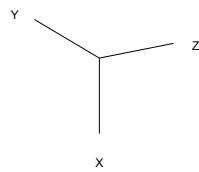

Flatness A

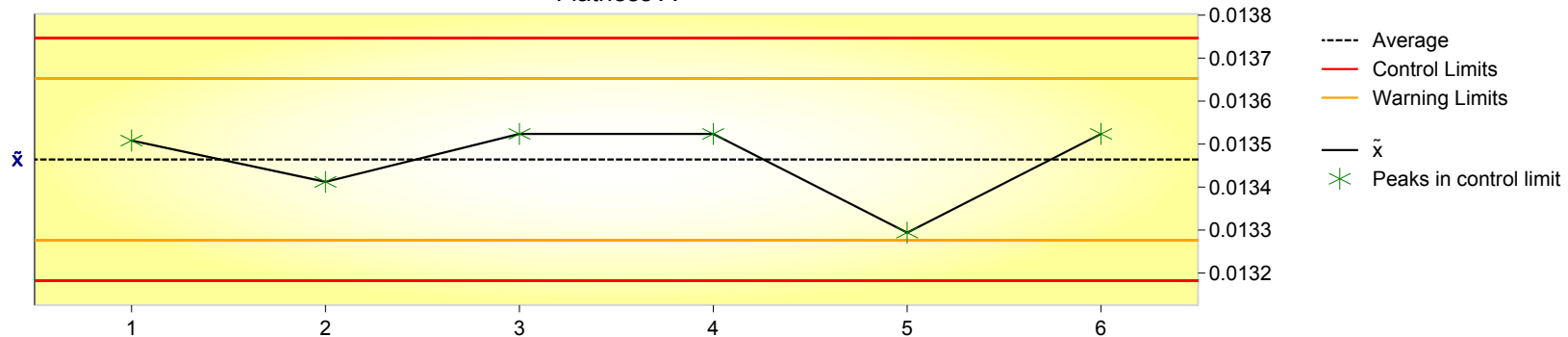

HOME

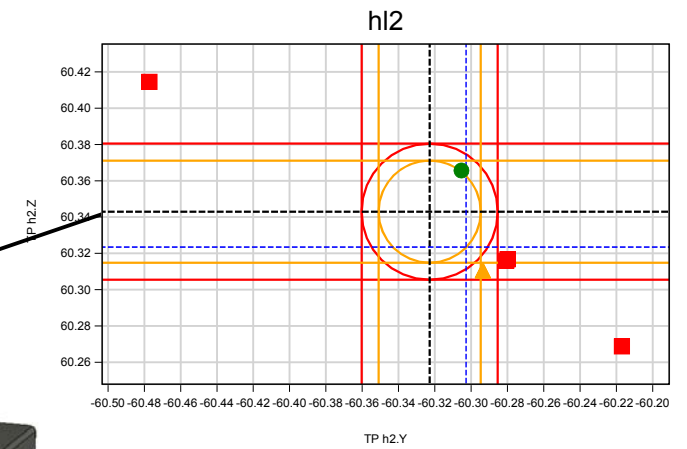
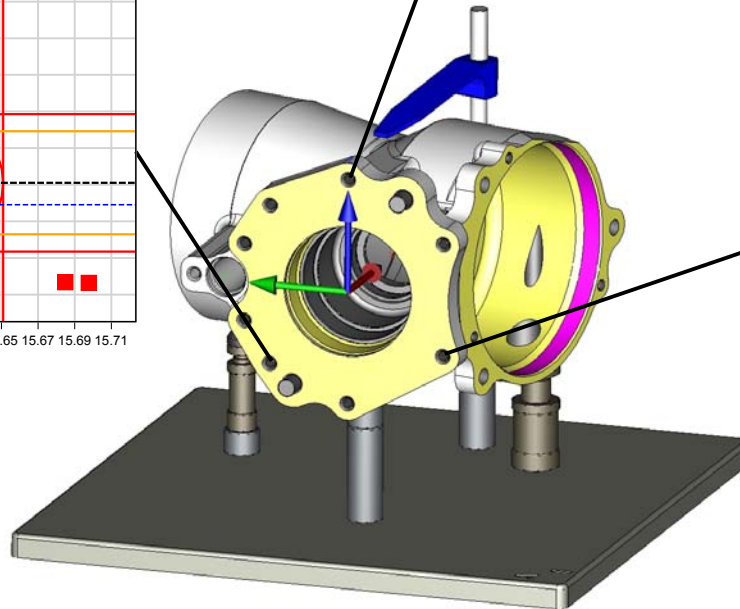
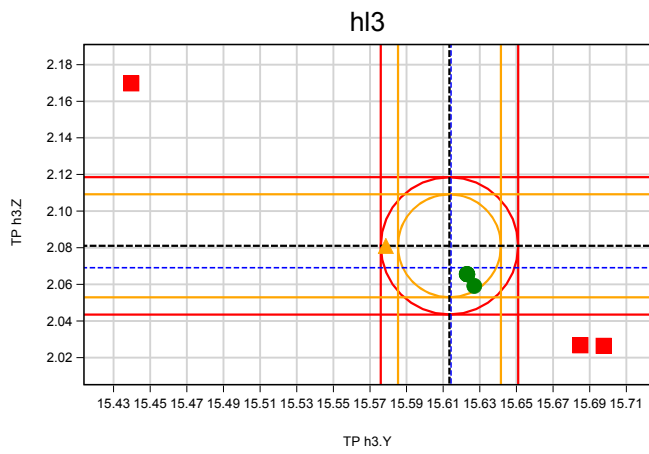
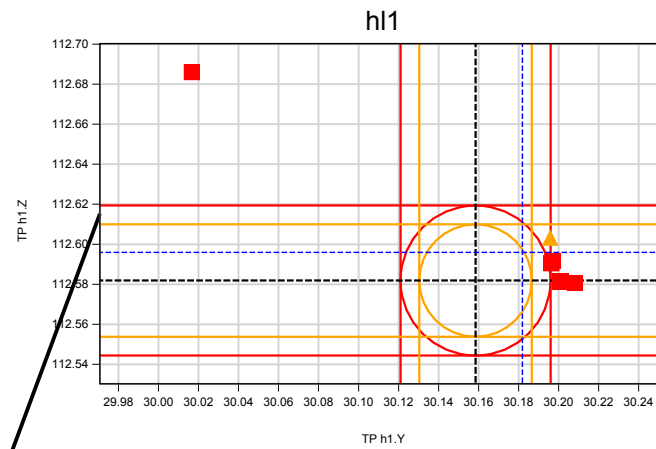
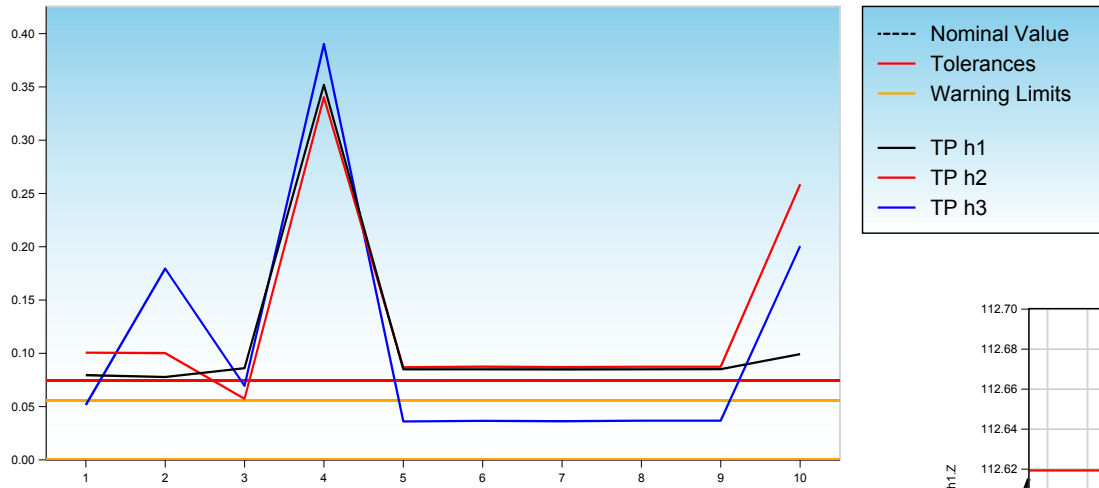

Print this page

HOME

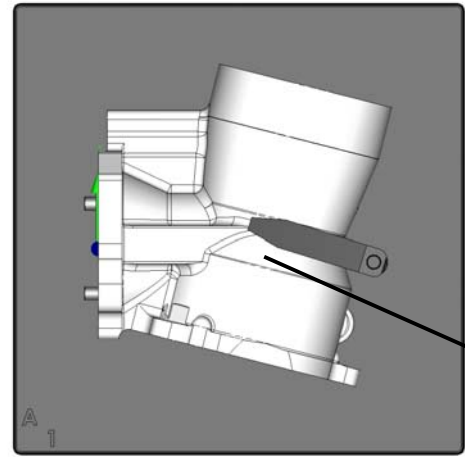
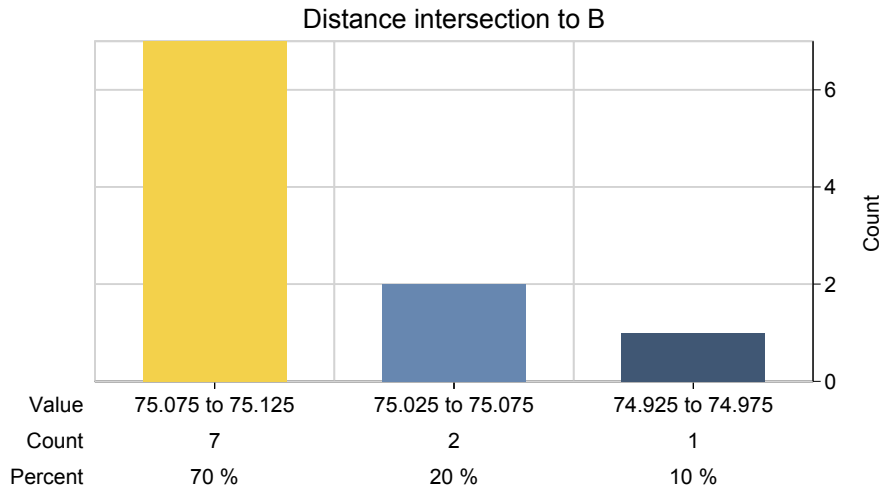

Distance intersection to B

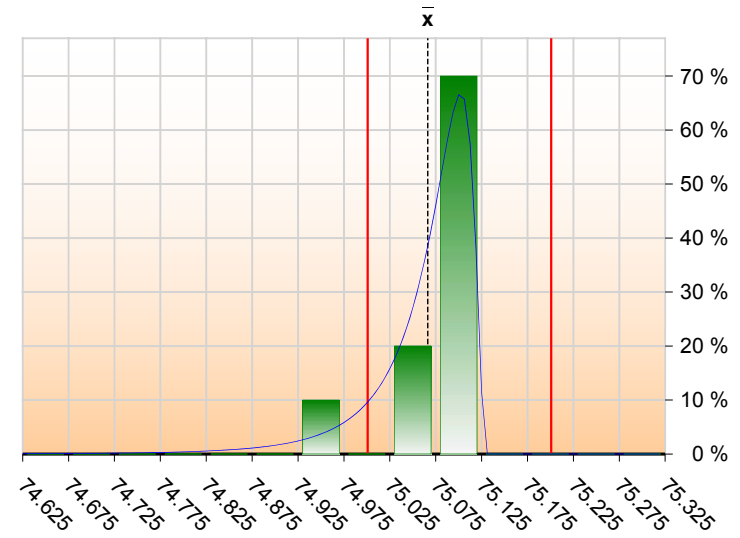
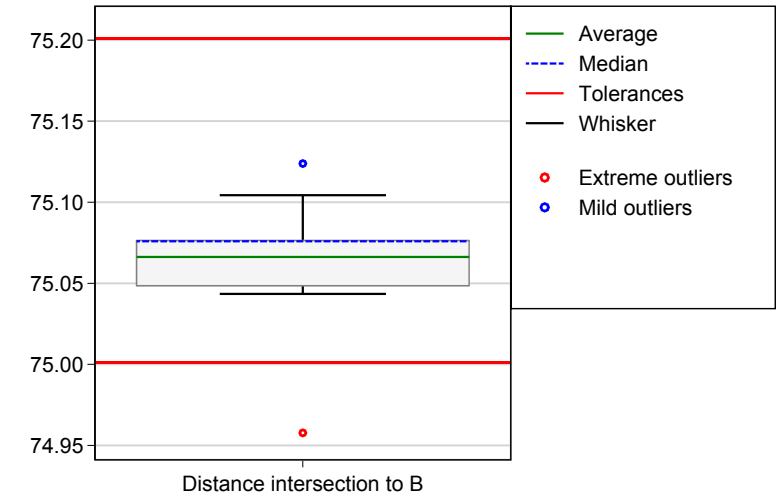
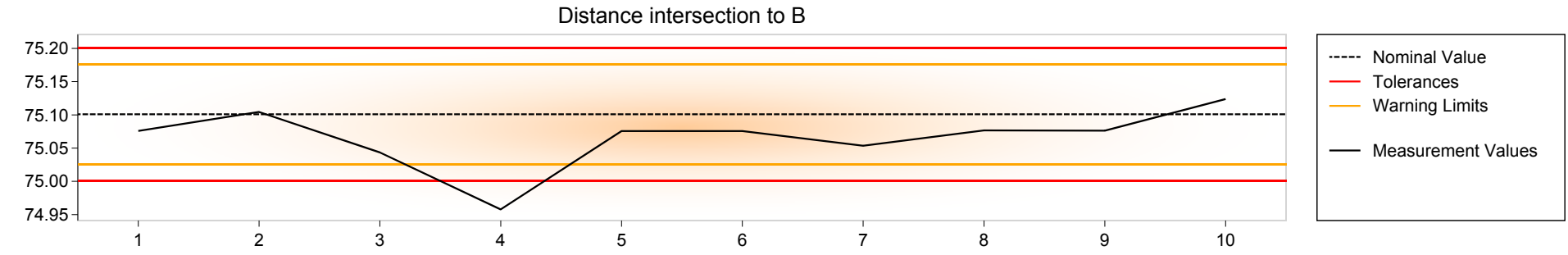

HOME



- 20.934 to 20.9345
- 20.935 to 20.9355
- 20.9355 to 20.936
- 20.936 to 20.9365
- 20.937 to 20.9375

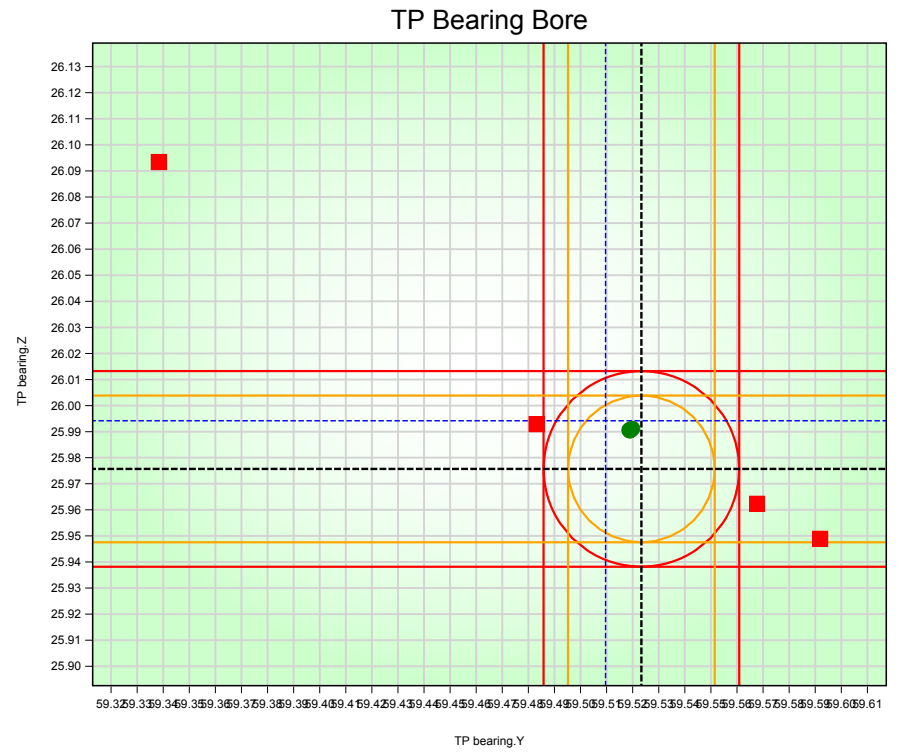
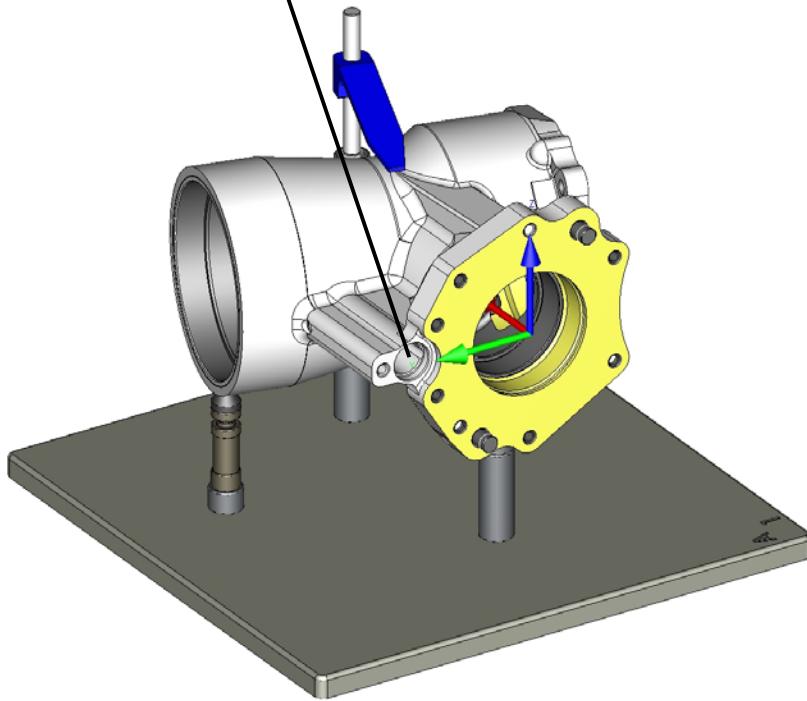
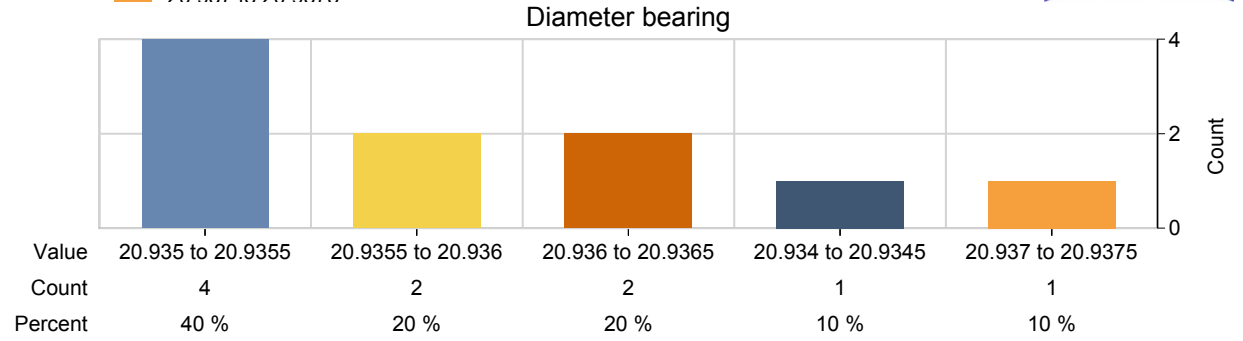
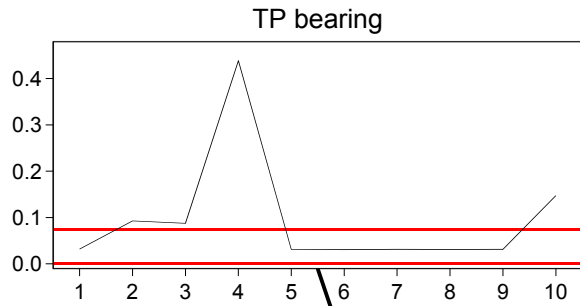

Print this page

HOME

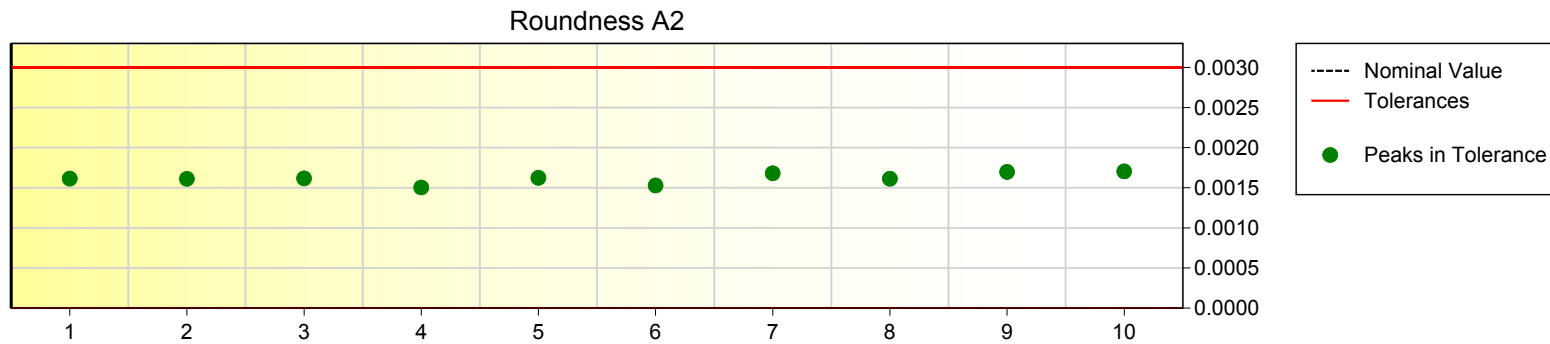
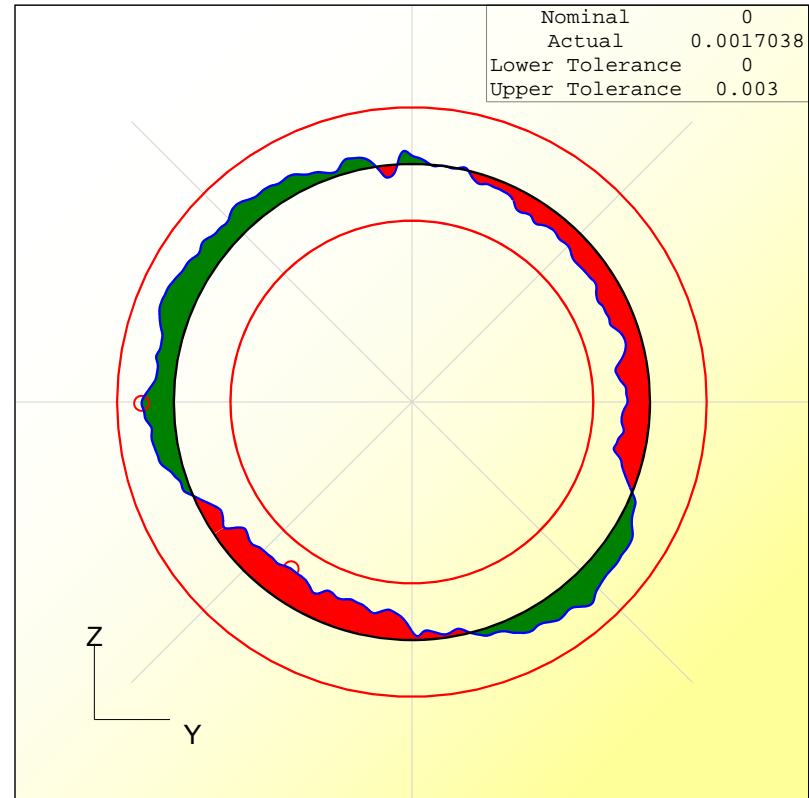
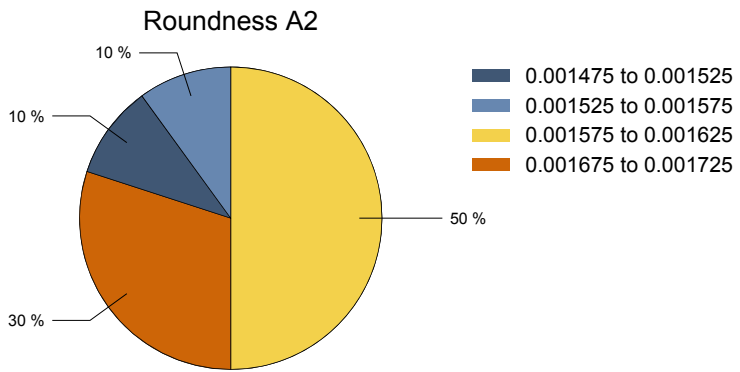
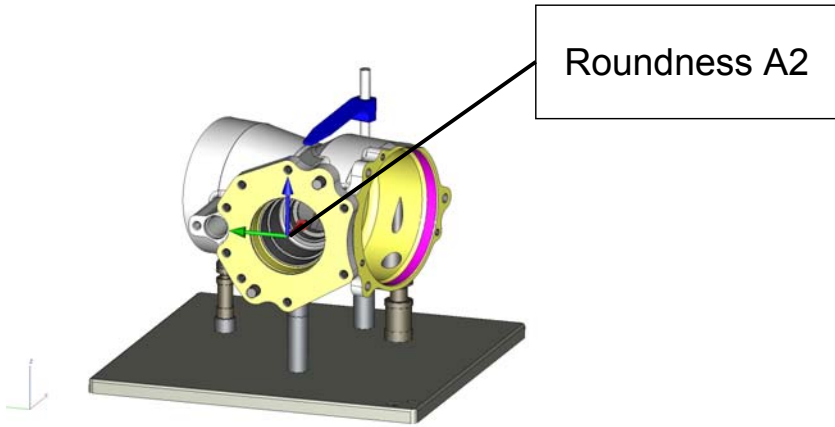

HOME